

## Bolt connection terminal block - RWV 5 - 3073746

Please be informed that the data shown in this PDF Document is generated from our Online Catalog. Please find the complete data in the user's documentation. Our General Terms of Use for Downloads are valid (<http://download.phoenixcontact.com>)



Bolt connection terminal block, Connection method: Bolt connection, Load current : 76 A, Cross section: 0.1 mm<sup>2</sup> - 16 mm<sup>2</sup>, AWG 26 - 6, Connection direction of the conductor to plug-in direction: 90 °, Width: 16.3 mm, Color: gray

### Product Features

- ✓ Easy grouping with engagement pin versions
- ✓ Both terminal halves can be easily assembled by simply snapping them together
- ✓ Quick and easy conductor connection thanks to hinged cover flaps with captive clamping nut
- ✓ Molded versions ensure maximum tightness of seal
- ✓ Touch-proof insulating housing in a new design
- ✓ Spring-loaded spacers protect the bolt connection against loosening
- ✓ Automatic compensation of the panel thickness via the snap principle integrated in the insulation housing



### Key commercial data

|                                      |          |
|--------------------------------------|----------|
| Packing unit                         | 1 1      |
| Minimum order quantity               | 10 1     |
| Weight per Piece (excluding packing) | 40.0 GRM |
| Custom tariff number                 | 85369010 |
| Country of origin                    | China    |

### Technical data

#### General

|   |      |
|---|------|
| Number of levels                        | 1    |
| Number of connections                   | 2    |
| Color                                   | gray |
| Insulating material                     | PA   |
| Inflammability class according to UL 94 | V0   |
| Rated surge voltage                     | 8 kV |
| Pollution degree                        | 3    |

## Bolt connection terminal block - RWV 5 - 3073746

### Technical data

#### General

|                                  |               |
|----------------------------------|---------------|
| Surge voltage category           | III           |
| Insulating material group        | I             |
| Connection in acc. with standard | IEC 60947-7-1 |
| Nominal current $I_N$            | 76 A          |
| Nominal voltage $U_N$            | 1000 V        |
| Open side panel                  | ja            |
| Number of positions              | 1             |

#### Dimensions

|       |         |
|-------|---------|
| Width | 16.3 mm |
|-------|---------|

#### Connection data

|  |                         |
|--|-------------------------|
| Note                                   | Connection bolts        |
| Connection side                        | Level 1 above 1 below 1 |
| Connection method                      | Bolt connection         |
| Conductor cross section solid min.     | 0.1 mm <sup>2</sup>     |
| Conductor cross section solid max.     | 16 mm <sup>2</sup>      |
| Conductor cross section stranded min.  | 0.1 mm <sup>2</sup>     |
| Conductor cross section stranded max.  | 16 mm <sup>2</sup>      |
| Conductor cross section AWG/kcmil min. | 26                      |
| Conductor cross section AWG/kcmil max  | 6                       |
| Screw thread                           | M5                      |
| Tightening torque, min                 | 2.5 Nm                  |
| Tightening torque max                  | 3 Nm                    |

### Classifications

#### eCl@ss

|            |          |
|------------|----------|
| eCl@ss 4.0 | 27141131 |
| eCl@ss 4.1 | 27141131 |
| eCl@ss 5.0 | 27141134 |
| eCl@ss 5.1 | 27141134 |
| eCl@ss 6.0 | 27141134 |
| eCl@ss 7.0 | 27141134 |
| eCl@ss 8.0 | 27141134 |

#### ETIM

|          |          |
|----------|----------|
| ETIM 2.0 | EC001283 |
|----------|----------|

## Bolt connection terminal block - RWV 5 - 3073746

### Classifications

#### ETIM

|          |          |
|----------|----------|
| ETIM 3.0 | EC001283 |
| ETIM 4.0 | EC000897 |
| ETIM 5.0 | EC001283 |

#### UNSPSC

|               |          |
|---------------|----------|
| UNSPSC 6.01   | 30211811 |
| UNSPSC 7.0901 | 39121410 |
| UNSPSC 11     | 39121410 |
| UNSPSC 12.01  | 39121410 |
| UNSPSC 13.2   | 39121410 |

### Approvals

#### Approvals

---

#### Approvals

UL Recognized / GOST / GOST

---

#### Ex Approvals

---

#### Approvals submitted

---

#### Approval details

|                                |       |       |
|--------------------------------|-------|-------|
| UL Recognized                  |       |       |
|                                | B     | C     |
| Nominal current I <sub>N</sub> | 65 A  | 65 A  |
| Nominal voltage U <sub>N</sub> | 600 V | 600 V |

|      |  |  |
|------|--|--|
| GOST |  |  |
|------|--|--|

## Bolt connection terminal block - RWV 5 - 3073746

### Approvals



### Accessories

#### Accessories

#### Flange

Flange cover - RWV 5-F - 3075317



Flange cover, Color: gray

#### Screwdriver tools

Screwdriver - SZS 1,0X6,5 VDE - 1205079



Screwdriver, slot-headed, VDE insulated, size: 1.0 x 6.5 x 150 mm, 2-component grip, with non-slip grip

#### Terminal marking

Marker for terminal blocks - UC-TM 12 - 0819194



Marker for terminal blocks, Sheet, white, Unlabeled, Can be labeled with: BLUEMARK CLED, BLUEMARK LED, Plotter, Mounting type: Snap into tall marker groove, For terminal block width: 12 mm, Lettering field: 11.45 x 10.5 mm

Marker for terminal blocks - UC-TM 16 - 0819217



Marker for terminal blocks, Sheet, white, Unlabeled, Can be labeled with: BLUEMARK CLED, BLUEMARK LED, Plotter, Mounting type: Snap into tall marker groove, For terminal block width: 16 mm, Lettering field: 15.45 x 10.5 mm

## Bolt connection terminal block - RWV 5 - 3073746

### Accessories

---

#### Marker for terminal blocks - UC-TMF 12 - 0819233



Marker for terminal blocks, Sheet, white, Unlabeled, Can be labeled with: BLUEMARK CLED, BLUEMARK LED, Plotter, Mounting type: Snap into flat marker groove, For terminal block width: 12 mm, Lettering field: 11.45 x 5.1 mm

#### Marker for terminal blocks - UC-TMF 16 - 0819262



Marker for terminal blocks, Sheet, white, Unlabeled, Can be labeled with: BLUEMARK CLED, BLUEMARK LED, Plotter, Mounting type: Snap into flat marker groove, For terminal block width: 16 mm, Lettering field: 15.45 x 5.1 mm

#### Marker for terminal blocks - TMT (EX9,5)R - 0828295



Marker for terminal blocks, Roll, white, Unlabeled, Can be labeled with: THERMOMARK ROLL, THERMOMARK X, THERMOMARK S1.1, Mounting type: Snap into universal marker groove, Snap into flat marker groove, Lettering field: 9.5 x 50000 mm

### Drawings

Dimensioned drawing

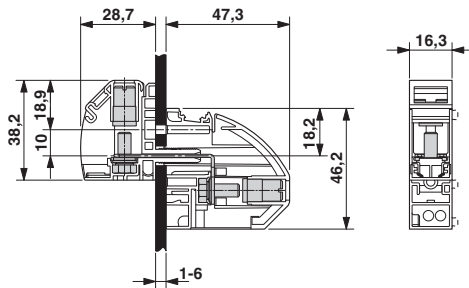

Dimensioned drawing

