

### SMA Female Jack to BMA Female Jack

Model Number

ADT-2767-SF-BMF-02

**SPECIFICATIONS**

**Frequency:** DC - 18.0 GHz

**VSWR:** 1.05 + .005 f (GHz)

**Impedance:** 50 Ohms

**Finish:** Passivated Stainless Steel

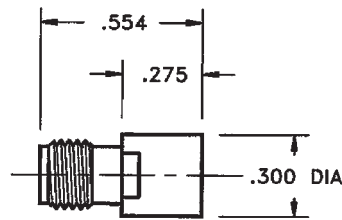

### SMA Female Jack to BMA Female Jack - Floating Panel Mount

Model Number

ADT-2808-SF-BMF-02

**SPECIFICATIONS**

**Frequency:** DC - 18.0 GHz

**VSWR:** 1.05 + .005 f (GHz)

**Impedance:** 50 Ohms

**Finish:** Passivated Stainless Steel

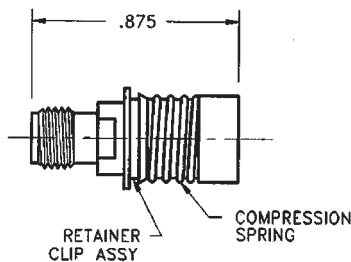

### SMA Female Jack to BMA Female Jack - Floating Panel Mount

Model Number

ADT-2809-SF-BMF-02

**SPECIFICATIONS**

**Frequency:** DC - 18.0 GHz

**VSWR:** 1.05 + .005 f (GHz)

**Impedance:** 50 Ohms

**Finish:** Passivated Stainless Steel

