

PRODUCT NUMBER	PITCH
VQxx11x000JOG	3.50 mm

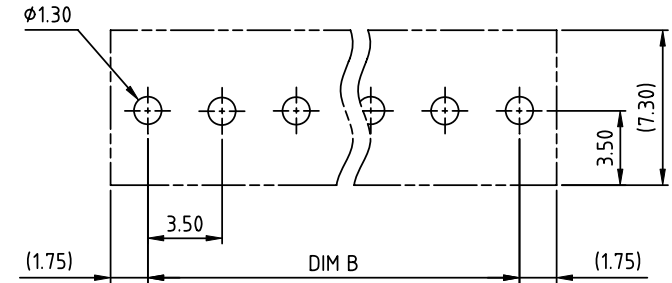

RECOMMENDED P.C.B LAYOUT
TOP VIEW

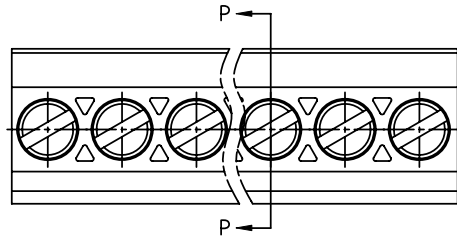
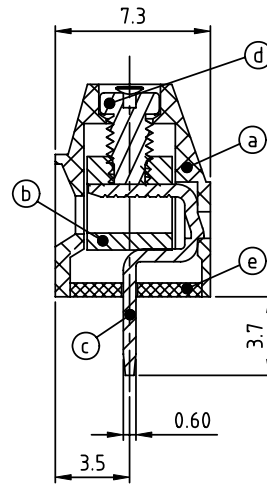
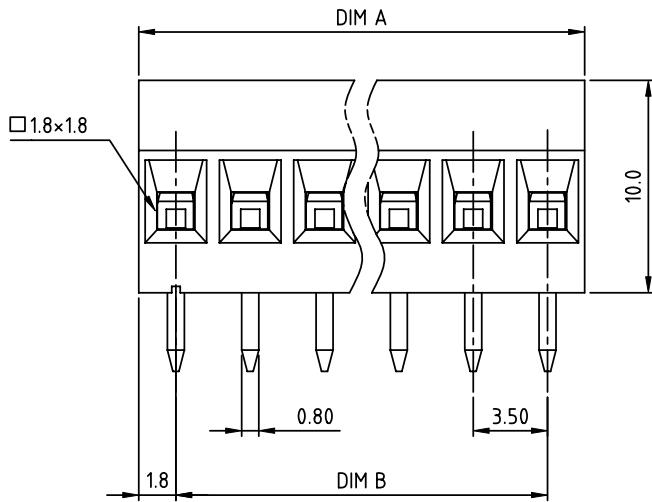

SECTION P-P

Material:

- Item (a) Terminal housing : Thermoplastic (UL 94V-0)
- Item (b) Clamp : Brass, Ni plated
- Item (c) solder pin : Brass, Tin plated
- Item (d) Terminal screw : Steel Zinc plating "-" slot type
- Item (e) Terminal cover : Thermoplastic (UL 94V-0)

Electrical:

- Voltage rating: 300V
- Current rating: 10A
- Wire range:
- Solid wire(AWG): 16-30
- Stranded wire(AWG): 16-30
- Torque: 1.7 Lb-In
- Screw: M2
- Wire strip length: 5-6mm
- Withstanding Voltage: 1.6 KV
- Operating temperature: -40°C to +115°C
- Soldering temperature: 260°C±5°C/5 Sec
- Safety Approval: cULus

N= Number of poles

DIM A	N×3.5
DIM B	(N-1)×3.5

Poles	Tolerance
2p-6p	±0.15
7p-12p	±0.25
13p-19p	±0.35
20p-24p	±0.40

PART NO.: VQ xx 1 1 x 0 00J0 G

- | | | | |
|--------------|---|-------------------|-----------------|
| Solid Block | 0 | Black (RAL9005) | RoHS compliant |
| No. of poles | 2 | Red (RAL3001/D) | (lead<4%) |
| 02 2 poles | 3 | Orange(RAL2011/P) | In copper Alloy |
| 03 3 poles | 4 | Yellow(RAL1018/A) | |
| ... | 5 | Green(RAL6018/T) | |
| 24 24 poles | 6 | Blue (RAL5015/A) | |
| | 8 | Grey(RAL7035/D) | |
| | 9 | White(RAL1102) | |
| | C | Green(RAL6018/U) | |

mat'l. code	surface ASME Y14.5	tolerance ASME Y14.5	projection	product family TERMINAL BLOCK
ltr	ecn	no	dr	date
tolerances unless otherwise specified			MM	title TERMINAL BLOCK RISING CLAMP,180D WIRE INLET,DIP SOLDER
angles	φ	X.±0.5		
±	±	X.X±0.3		
X*±1*			X.XX±0.1	scale
dr	EVIN ZHONG	040714	FCI	dwg no VQxx11x000JOG
enrg	EVIN ZHONG	040714		
chr	HANKE FENG	040714		
appd	SHI JUN	040714		
sheet index	revision	A	sheet 1 of 1 size A4	
sheet	1		type CUSTOMER Drawing	