

MODEL NUMBER
TRM-2160-M0-35M-02

NOTES:

1.0 ELECTRICAL SPECIFICATIONS:

1.1 FREQUENCY RANGE: DC to 26.5 GHz

1.2 MAXIMUM VSWR:

DC to 18.0 GHz: 1.12:1

18.0 to 26.5 GHz; 1.18:1

1.3 MAXIMUM INPUT POWER: 2 WATTS AT +25°C DERATED LINEARLY TO 1 WATT AT +125°C.

1.4 OPERATING TEMP. RANGE: -65°C to +125°C

2.0 MARKING (MARK UNIT AS SHOWN):
(REF.: INK-02639-27-10)

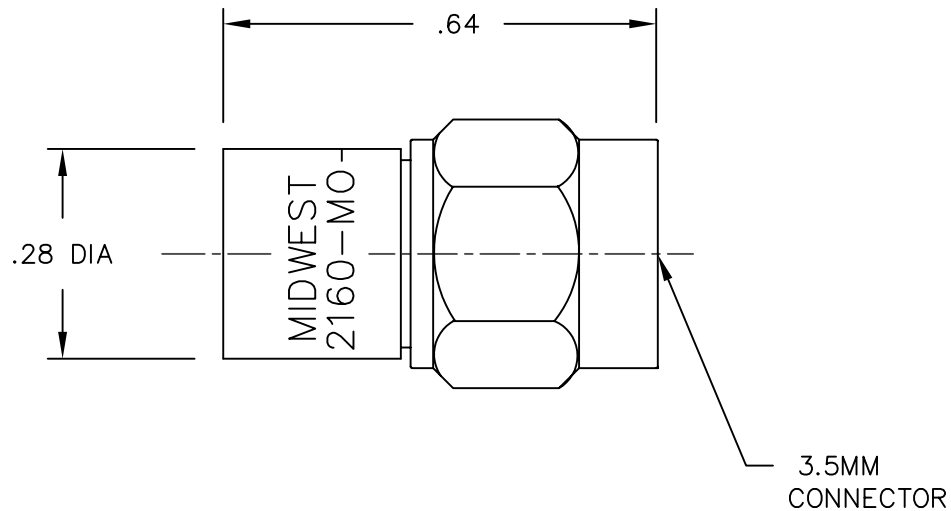

DWG NO. WAS: 06612-01-00

| REV. | DESCRIPTION | DATE |
|------|------------------|---------|
| - | RELEASED | 2/26/86 |
| A | ECR 4962 | 11/6/86 |
| B | ECR 6545 | 8/1/89 |
| C | ECR 6933 | 8/1/89 |
| C1 | UPDATE DWG NO. | 5/17/91 |
| D | ECN 11825 | 5/18/92 |
| E | ECN 11948 | 8/6/92 |
| E1 | ADDED TITLEBLOCK | 11/9/05 |

NOTICE: The information contained in this drawing is proprietary and must not be used without the permission of Emerson Network Power.

UNLESS OTHERWISE NOTED DIMENSIONS ARE IN INCHES AND TOLERANCES ARE:
3 PLACE DECIMALS ±.005
2 PLACE DECIMALS ±.02
FRACTIONS ±1/64
PARALLELITY: T.I.R. _____
FLATNESS: T.I.R. _____
CONCENTRICITY: T.I.R. _____
ANGLES AND PERPENDICULARITY: ±1'

| | | | |
|---|--|---|---------------------------------|
| CAGE CODE 34078 | | MIDWEST MICROWAVE | |
| | | TITLE TERMINATION OUTLINE DRAWING | |
| | | DRAWN/DATE A.BEATTY 5/18/92 | ENG./DATE G.KOZAK 5/19/92 |
| CHECKED/DATE M.HOLLMAN 5/18/92 | | APPROVED/DATE | |
| DRAWING NUMBER TRM-2160-M0-35M-02-01 | | REV. E1 | |
| SCALE: 5=1 | | SHEET 1 of 1 | |