

LOC		DIST		REVISIONS			
CM	O	REV	DESCRIPTION	DATE	BY	APPV	
		D	REVISED PER ECO-08-008919	16APR08	HMR	DB	
		D1	REVISED PER ECO-09-021510	15SEP09	KK	AEG	

- MATERIAL: CONNECTOR- NYLON UL94V-2 (WHITE).  
 CONTACTS- 0.30 [.012] THK COPPER ALLOY  
 (BRIGHT TIN-LEAD 0.00203 [.000080] MIN THK).  
 (MATTE TIN 0.00203 [.000080] MIN THK).
- CONTACTS ACCEPT #24 AWG SOLID, FUSED STRANDED OR STRANDED (7 STRANDS) WIRE WITH 2.41 [.095] MAX INSULATION DIA.
- BOW, IN ANY DIRECTION, NOT TO EXCEED 0.15 [.006] PER IN.
- HOUSING FEATURES: FEED-THRU.
- DIMENSIONS IN BRACKETS ARE IN INCHES.
- ⚠️ OBSOLETE PARTS: OBSOLETE CIS STREAMLINING PER D.RENAUD/D.SINISI

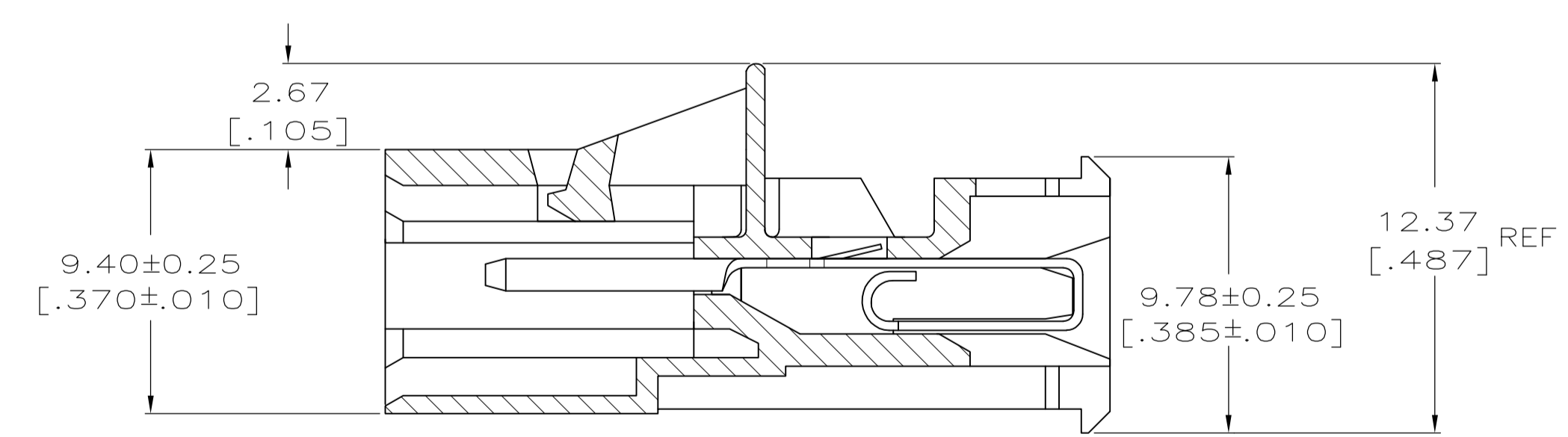
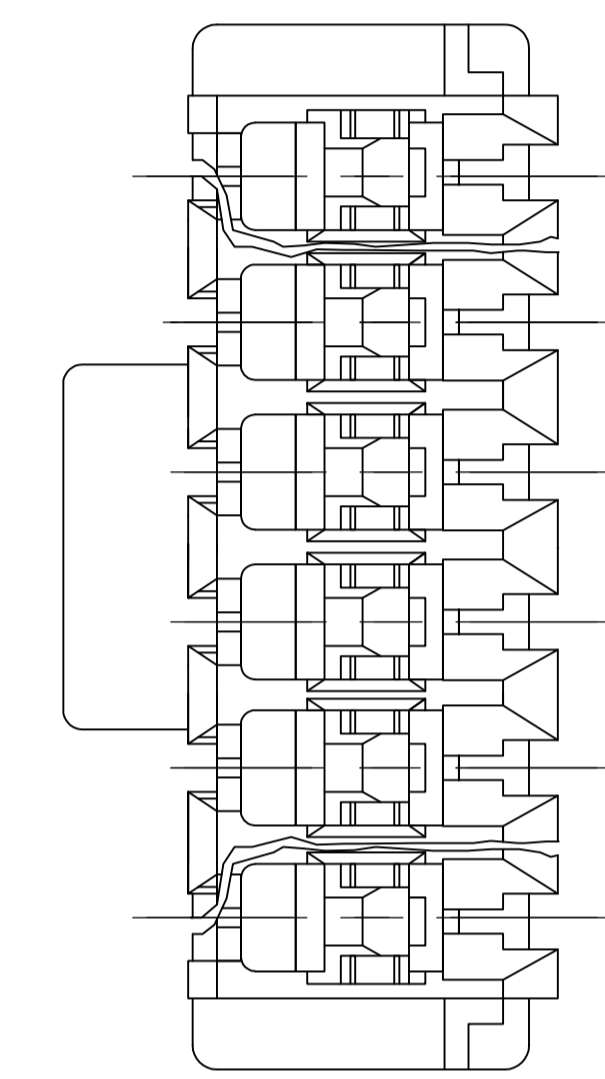
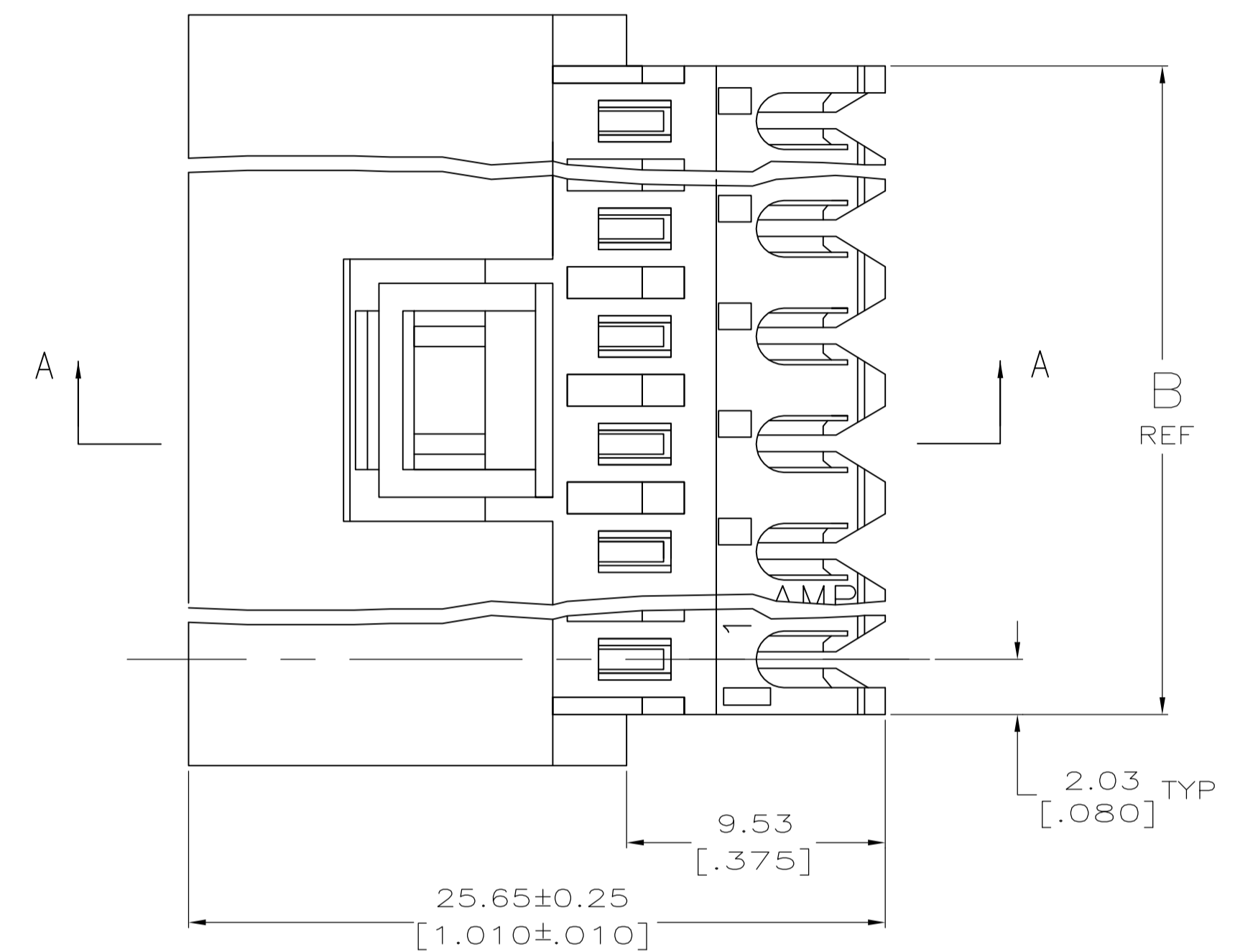
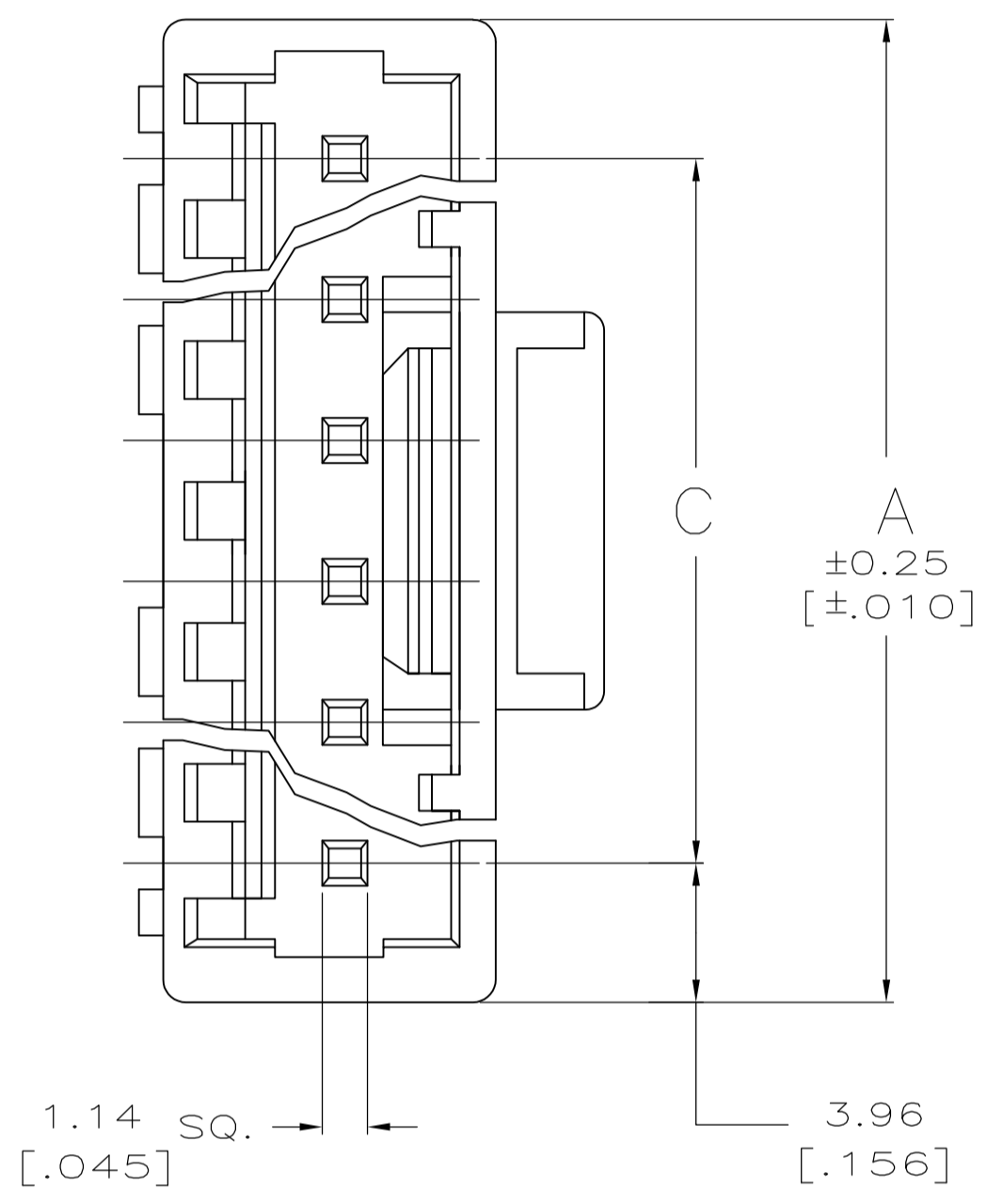

SECTION A-A

FINISH	C	B	A	NO. OF CIRCUITS	PART NUMBER
⚠️ OBSOLETE	TIN	91.14 [3.588]	95.20 [3.748]	99.06 [3.900]	24 -5-641525-4
⚠️ OBSOLETE	TIN	55.47 [2.184]	59.54 [2.344]	63.40 [2.496]	15 -4-641525-5
⚠️ OBSOLETE	TIN	43.59 [1.716]	47.65 [1.876]	51.51 [2.028]	12 -4-641525-2
⚠️ OBSOLETE	TIN	31.70 [1.248]	35.76 [1.408]	39.62 [1.560]	9 -3-641525-9
⚠️ OBSOLETE	TIN	19.81 [.780]	23.88 [.940]	27.74 [1.092]	6 -3-641525-6
⚠️ OBSOLETE	TIN	11.89 [.468]	15.95 [.628]	19.81 [.780]	4 -3-641525-4
⚠️ OBSOLETE	TIN	7.92 [.312]	11.99 [.472]	15.85 [.624]	3 -3-641525-3
⚠️ OBSOLETE	TIN	3.96 [.156]	8.03 [.316]	11.89 [.468]	2 -3-641525-2
⚠️ OBSOLETE	TIN-LEAD	91.14 [3.588]	95.20 [3.748]	99.06 [3.900]	24 -2-641525-4
⚠️ OBSOLETE	TIN-LEAD	55.47 [2.184]	59.54 [2.344]	63.40 [2.496]	15 -1-641525-5
⚠️ OBSOLETE	TIN-LEAD	43.59 [1.716]	47.65 [1.876]	51.51 [2.028]	12 -1-641525-2
⚠️ OBSOLETE	TIN-LEAD	31.70 [1.248]	35.76 [1.408]	39.62 [1.560]	9 -641525-9
⚠️ OBSOLETE	TIN-LEAD	19.81 [.780]	23.88 [.940]	27.74 [1.092]	6 -641525-6
⚠️ OBSOLETE	TIN-LEAD	11.89 [.468]	15.95 [.628]	19.81 [.780]	4 -641525-4
⚠️ OBSOLETE	TIN-LEAD	7.92 [.312]	11.99 [.472]	15.85 [.624]	3 -641525-3
⚠️ SUPERSEDED	TIN-LEAD	3.96 [.156]	8.03 [.316]	11.89 [.468]	2 -641525-2

THIS DRAWING IS A CONTROLLED DOCUMENT. DWN B. LEWIS 5-28-96  
 CJK R. SWING 5-28-96  
 Tyco Electronics Corporation Harrisburg, PA 17105-3608

DIMENSIONS: mm [INCHES]	TOLERANCES UNLESS OTHERWISE SPECIFIED:	PRODUCT SPEC	NAME
0 PLC ± -	1 PLC ± -	APPLICATION SPEC	MTA-156
2 PLC ± 0.13 [.005]	3 PLC ± -	SIZE	CAGE CODE
4 PLC ± -	ANGLES ± -	WEIGHT	DRAWING NO.
MATERIAL SEE NOTE 1	FINISH SEE NOTE 1	SCALE	RESTRICTED TO
		A1 00779 C=641525	MTA-156 POSTED CONNECTOR ASSEMBLY, 24 AWG
		CUSTOMER DRAWING	SCALE 5:1 SHEET 1 OF 1 REV D1